



Pushbutton Switches Series ZR18-29

General Specifications

Contact Resistance : 30m Ohm Max(initial)
 Insulation Resistance : DC 500V 100M Ohm Min
 Dielectric strength : AC 1000V 1 Minute
 Operating Force : 0.3Kgf (Min)
 Solder ability of terminal : 250°C for 2 seconds
 Operating Temperature : 0°C ~ + 65°C



ZR18-29 Series	ZR18-29A-□	ZR18-29B-□	ZR18-29C-□
Circuit	(ON)-OFF	ON-(OFF)	ON-OFF
Rating	1A 250VAC / 3A 125VAC	1A 250VAC / 3A 125VAC	1A 250VAC
Electrical Life	6,000 Cycle Min.	6,000 Cycle Min.	10,000 Cycle Min.
Mechanical Life	10,000 Cycle Min.	10,000 Cycle Min.	20,000 Cycle Min.

Material

Cap : Acrylonitrile Butadine Styrene (ABS)
 Case Cap : Zinc Casting Alloys
 Case : Polyarylethersulfone(PES) for ZR18-29A , ZR18-29B
 Polyamide (PA) for ZR18-29C
 Spring : Piano wire
 Terminal : Copper Alloy, silver or gold plating

Application

Public building , Home Security , Business building , Industrial equipment

Instal Hole

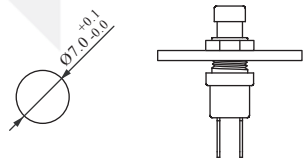

How to order

/ ZR18-29A

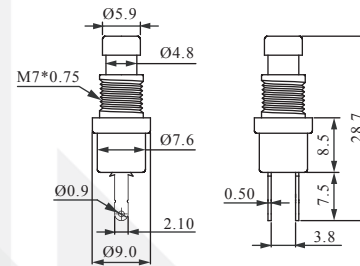

ZR18-29A-B
 (ON)-OFF
 Momentary
 Black cap



ZR18-29A-R
 (ON)-OFF
 Momentary
 Red cap

/ ZR18-29B

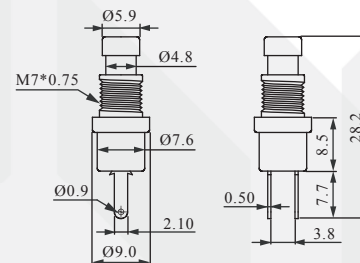

ZR18-29B-B
 ON-(OFF)
 Momentary
 Black cap



ZR18-29B-R
 ON-(OFF)
 Momentary
 Red cap

/ ZR18-29C

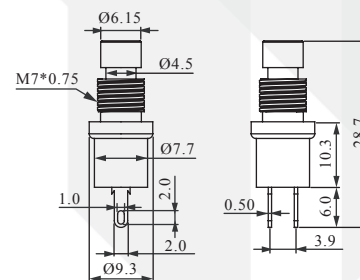

ZR18-29C-B
 ON-OFF
 Alternate
 Black cap



ZR18-29C-R
 ON-OFF
 Alternate
 Red cap